



KM Heavy Duty Limit Switches

特徵

- 堅硬金屬外殼，極大搖臂角度±95°
- 特長2000萬次機械壽命
- 不鏽鋼滾輪，衝頭及彈簧
- 可選配PG11固定頭

接點型式

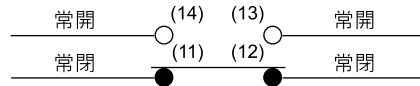

規格

型號	KM	D10	D02	D23	D16	D41	D06	D66	D08
動作所需力量	OF (最大)	400g	800g	800g	400g-cm	400g-cm	150g	150g	150g
復歸力	RF (最小)	1.8mm	400g	400g	100g-cm	100g-cm	50g	50g	50g
動作前移動	PT (最大)	2.0mm	1.8mm	1.8mm	20°	20°	30mm	30mm	30mm
觸發位置	TP±10%	1.2mm	2.0mm	2.0mm	22.5°	22.5°	22.5°	22.5°	22.5°
應差移動	MD (最大)	4.0mm	1.2mm	1.2mm	10°	10°	14°	14°	14°
動作後移動	OT (最小)	5.8mm	4.0mm	4.0mm	75°	75°	20mm	20mm	20mm
整體移動	TT (最小)		5.8mm	5.8mm	95°	95°	50mm	50mm	50mm
搖臂轉換分角度					22.5°	22.5°			

特性

雙斷開機械功用	1NO+1NC Force Break snap action
額定電壓/電流	10(4)A, 125, 250VAC / 6(2)A, 380VAC For inductance Load, Cos φ = 0.4
接觸阻抗	25mΩ max. (initial value)
絕緣阻抗	100mΩ min. (at 500VDC)
耐電壓	1000VAC, 50/60 Hz for 1 minute between terminals of the same polarity
	1500VAC, 50/60 Hz for 1 minute between current-carrying and non-current-carrying metal parts
	1500VAC, 50/60 Hz for 1 minute between each terminal and ground
電氣壽命	500,000 at 10A 250VAC Resistive
機械壽命	10, 000, 000 operations min. (under rated conditions)
容許操作速度	5mm/s to 0.5m/s
保護構造	IP66
上升溫度	Max 30°C over ambient temperature at rated voltage/current
使用周圍溫度	-5°C~+65°C (with no icing)
保存溫度	-5°C~+65°C (with no icing)
使用周圍濕度	95% RH Max.
衝擊系數	Mechanical durable: 1000m/s ² min.
	Malfunction: 300m/s ² min.
振動頻率	Malfunction: 10 to 55Hz, 1.5mm double amplitude
端子螺絲扭力	6-8 kgf·cm
其他螺絲扭力	Cover 12-14 kgf·cm/Head 8-9 kgf·cm/Mounting 50-60 kgf·cm
裸銅線尺寸	φ 2 Max
電纜尺寸	φ 12 Max(IP 65 if use cable φ 8-9)

外觀和尺寸

KM-D10

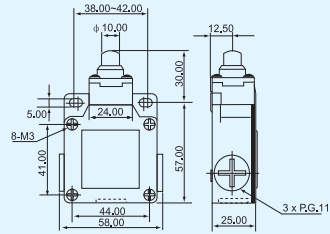

KM-D02

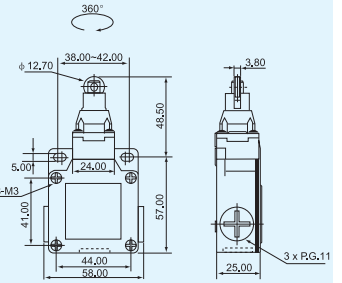

KM-D23

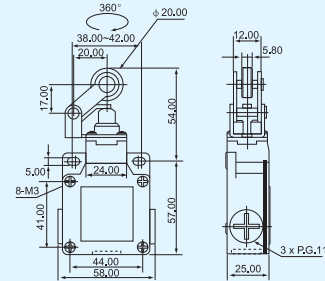

KM-D41

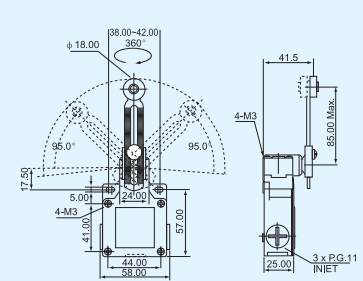

KM-D16

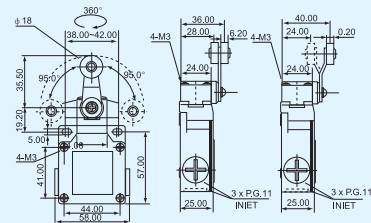

KM-D06

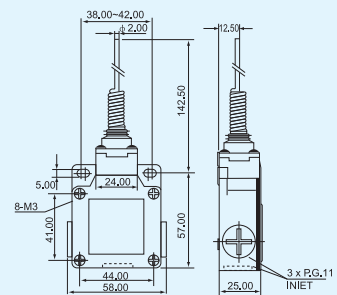

KM-D66

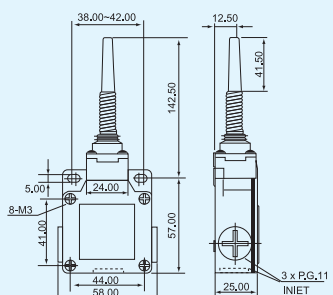

KM-D08

